

Introducing the *WITBH*— Blind Hole Mounted Cable Ties

Features and Benefits

- Barbed mounting head grips to the inside of a hole
- Ribs deflect when pushed into hole then spring back for a secure lock
- Easily inserted into threaded, non-threaded, drilled or punched hole
- Can be mounted to a variety of materials: wood, threaded metal, particle board, plastic, foam or rubber
- Reduces the number of inventoried parts by eliminating the need for a cable tie mount
- 50 Lb. (22 Kg) Tensile Strength
- Available in standard Nylon 6/6 and Heat Stabilized Nylon 6/6, serviceable to 286° F (141°C)

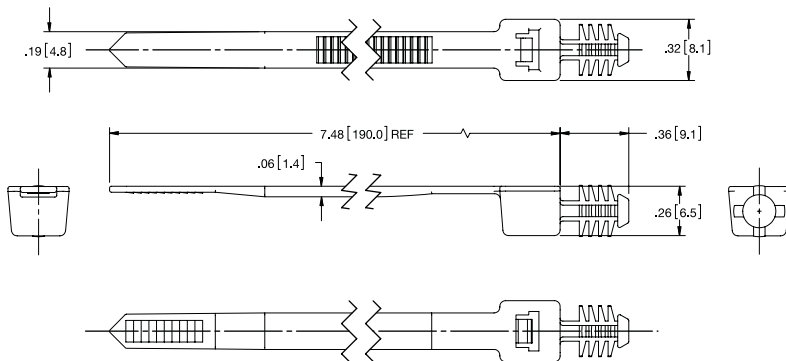
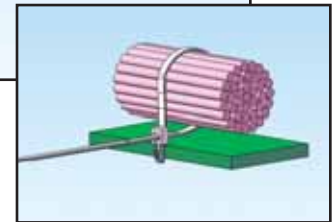
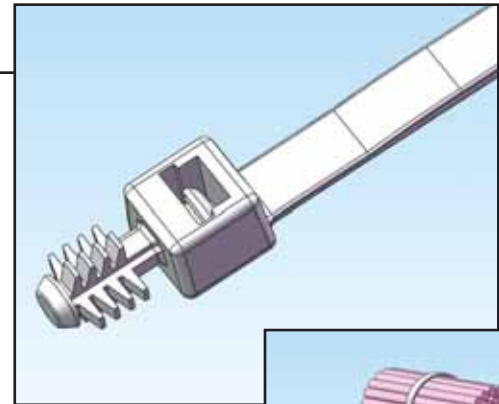

Markets

- Consumer Electronics
- Automotive
- White Goods
- Telecommunications
- Medical Equipment

Other Related Richco Product Solutions



FTH-15



TOAH



TOBS



RBF



LWSBH



BHLWHC

Part No.	Min. Loop Tensile Strength lb (kg.)	Max Bundle Dia	Hole Dia	Min Panel Thickness	Color	Material	Standard Pack
WITBH-50R	50 (22)	1.75 (44.5)	.250±.003 (6.35)	.25 (6.35)	Natural	Nylon 6/6, RMS-01	1,000
WITBH-50R-HS					Black	Heat Stabilized Nylon 6/6, RMS-47	

Other colors and materials are available by special order.

