



SINGLE AND DUAL SIDED HORIZONTAL CARD GUIDES

NEW PRODUCT RELEASE

Richco Inc. introduces a new line of snap-in horizontal card guides. Richco now offers a single-sided (RSSHG) and dual-sided (RDSHG) horizontal card guide series with lengths of 2" up to 6". The dual-sided version offers the ability to place two circuit boards side by side.

TARGET MARKETS

- ELECTRONICS

PART FEATURES

- From 2" up to 6" lengths
- Card channel on both sides for dual-sided version

BENEFITS

- Varying board sizes accepted
- Side-by-side board mounting possible with dual-sided version

| Material: Nylon 6/6 • Color: Black | | | |
|------------------------------------|---------------------|-------------------|--------------------|
| Part No. | Standard Pack: 1000 | | |
| | "A" ± .016 (0.40) | "B" ± .016 (0.40) | "C" ± .005 (0.127) |
| RSSHG-201-165 | 2 (50.8) | 1 (25.4) | .165 (4.2) |
| RSSHG-251-165 | 2.5 (63.5) | 1.5 (38.1) | |
| RSSHG-301-165 | 3 (76.2) | 2 (50.8) | |
| RSSHG-351-165 | 3.5 (88.9) | 2.5 (63.5) | |
| RSSHG-401-165 | 4 (101.6) | 3 (76.2) | |
| RSSHG-451-165 | 4.5 (114.3) | 3.5 (88.9) | |
| RSSHG-501-165 | 5 (127.0) | 4 (101.6) | |
| RSSHG-551-165 | 5.5 (139.7) | 4.5 (114.3) | |
| RSSHG-601-165 | 6 (152.4) | 5 (127.0) | |

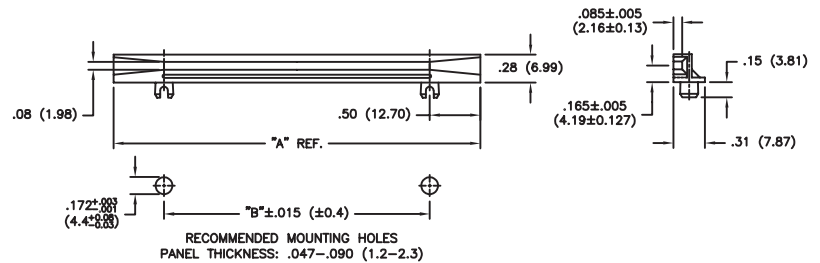

RSSHG

| Material: Nylon 6/6 • Color: Black | | | |
|------------------------------------|---------------------|-------------------|--------------------|
| Part No. | Standard Pack: 1000 | | |
| | "A" ± .016 (0.40) | "B" ± .016 (0.40) | "C" ± .005 (0.127) |
| RDSHG-202-165 | 2 (50.8) | 1 (25.4) | .165 (4.2) |
| RDSHG-252-165 | 2.5 (63.5) | 1.5 (38.1) | |
| RDSHG-302-165 | 3 (76.2) | 2 (50.8) | |
| RDSHG-352-165 | 3.5 (88.9) | 2.5 (63.5) | |
| RDSHG-402-165 | 4 (101.6) | 3 (76.2) | |
| RDSHG-452-165 | 4.5 (114.3) | 3.5 (88.9) | |
| RDSHG-502-165 | 5 (127.0) | 4 (101.6) | |
| RDSHG-552-165 | 5.5 (139.7) | 4.5 (114.3) | |
| RDSHG-602-165 | 6 (152.4) | 5 (127.0) | |

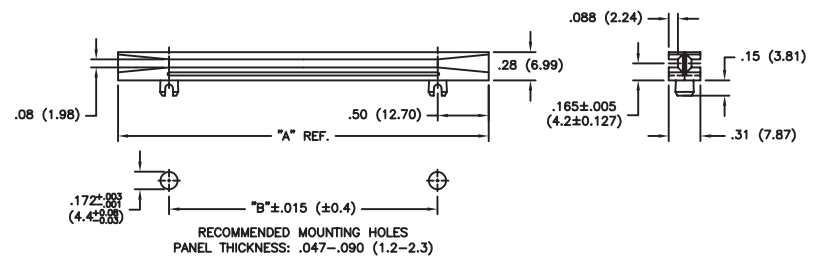

RDSHG